



Our kids are our passion.™

2241 N. Madera Rd

NXT-SE
Generation NEXT

Simi Valley, CA 93065

Phone: (800) 331-8551 Fax: (888) 582-1509

www.freedomdesigns.com

Pediatric Manual Wheelchair Transport Package Optional



Bill to:	Date: _____ P.O. # _____	Ship to:	Company: _____
	Company: _____		Address: _____
	Buyer: _____		City: _____ State: ____ Zip: _____
	Marked For: _____		Phone: _____

Description	Part No.	Retail	Description	Part No.	Retail
NXT Frame Type			Frame Dimensions		
			Specify Frame Width		
<input checked="" type="radio"/> Folding NXT - Pediatric (E1234)	NXT-30304	\$2650	<input type="radio"/> 10"	<input type="radio"/> 11"	<input type="radio"/> 12" NXT-30250 n/c
<input checked="" type="radio"/> Rigid NXT - Pediatric (E1233)	NXT-30314	\$2525	<input type="radio"/> 11"	<input type="radio"/> 12"	<input type="radio"/> 13" NXT-30210 n/c
Note: A seating system must be purchased separately No seating system is provided			<input type="radio"/> 12"	<input type="radio"/> 13"	<input type="radio"/> 14" NXT-30220 n/c
Tilt Activations			<input type="radio"/> 13"	<input type="radio"/> 14"	<input type="radio"/> 15" NXT-30230 n/c
<input checked="" type="radio"/> Single Lever Hand Activated Tilt		n/c	<input type="radio"/> 14"	<input type="radio"/> 15"	<input type="radio"/> 16" NXT-30240 n/c
Note: Lever installed on and behind right back post tube Note: Not available with vent and battery tray options			<input type="radio"/> 15"	<input type="radio"/> 16"	<input type="radio"/> 17" NXT-30290 n/c
<input type="radio"/> Dual Lever Hand Activated Tilt		n/c	<input type="radio"/> 16"	<input type="radio"/> 17"	<input type="radio"/> 18" NXT-30260 n/c
Note: Must be selected for vent & battery tray options			Note: The 10" through 16" widths adjust 2 additional inches in width Any width between 10" and 18" may be specified		
<input checked="" type="radio"/> Single Pedal Foot Activated Tilt		n/c	Note: Frame width dimensions are measured from the outside of seat tube to outside of seat tube		
Note: Pedal installed inside right rear side frame Note: Not available with vent and battery tray options			Note: Vent tray and battery tray options only available on 14" and wider frames		
Vent & Battery Trays			Back Post Locations		
<input type="radio"/> Vent Tray - Fixed (E1029)	11-1000	\$413	Specify Frame Length		
<input type="radio"/> Battery Tray - Fixed	11-5000	\$386	<input type="radio"/> Short Frame & Short Tilt Bracket	NXT-30511	n/c
Note: Not available with transport option Note: Only on 14" and wider frames Note: Not available on short frames			<input type="radio"/> 12"	NXT-30504	n/c
Transport Option			<input type="radio"/> 13"	NXT-30505	n/c
<input type="radio"/> Transport Package	NXT-99997	\$200	<input type="radio"/> 14"	NXT-30506	n/c
Note: NXT with transport option is available installed on NXT frame only and with WC-19 approved Freedom Seating Systems installed on NXT Note: Not available with vent and battery trays			<input type="radio"/> 15"	NXT-30521	n/c
NXT Frame Colors			<input type="radio"/> 16"	NXT-30522	n/c
Powder Coat Applications			Note: 22" & 24" wheels not available with short frame and short tilt bracket Note: Floor to seat rail height range is 12.5" to 16.5"		
<input type="radio"/> Black	n/c	<input type="radio"/> Pacific Blue	n/c	<input type="radio"/> Medium Frame & Short Tilt Bracket	NXT-30512
<input type="radio"/> Blizzard Blue	n/c	<input type="radio"/> Passion Purple	n/c	<input type="radio"/> 14"	NXT-30506
<input type="radio"/> Blue Blast	n/c	<input type="radio"/> Pink Parfait	n/c	<input type="radio"/> 15"	NXT-30521
<input type="radio"/> Blue Stardust	n/c	<input type="radio"/> Really Red	n/c	<input type="radio"/> 16"	NXT-30522
<input type="radio"/> Cosmic Purple	n/c	<input type="radio"/> Red Sunset	n/c	<input type="radio"/> 17"	NXT-30523
<input type="radio"/> Extreme Green	n/c	<input type="radio"/> Sparkle Green	n/c	<input type="radio"/> 18"	NXT-30524
<input checked="" type="radio"/> Maple Syrup Brown	n/c	<input type="radio"/> Twilight	n/c	Note: 22" & 24" wheels not available with short frame and short tilt bracket Note: Floor to seat rail height range is 12.5" to 16.5"	
<input type="radio"/> Mystic Teal	n/c	<input type="radio"/> Yellow	n/c	<input type="radio"/> Medium Frame & Tall Tilt Bracket	NXT-30540
<input type="radio"/> Octane Orange	n/c	Note: Tall tilt bracket increases floor to seat rail height by 1.5"			
Powder Coat Applications with High Reflective Starlight			<input type="radio"/> 14"	NXT-30506TP	n/c
<input type="radio"/> Black High Reflective Starlight	NXT-BHRS	\$150	<input type="radio"/> 15"	NXT-30521TP	n/c
<input type="radio"/> Blue Blast Reflective Starlight	NXT-BBHRS	\$150	<input type="radio"/> 16"	NXT-30522TP	n/c
<input type="radio"/> Maple Syrup Brown Reflective Starlight	NXT-MSHRS	\$150	<input type="radio"/> 17"	NXT-30523TP	n/c
<input type="radio"/> Passion Purple High Reflective Starlight	NXT-PPHRS	\$150	<input type="radio"/> 18"	NXT-30524TP	n/c
<input type="radio"/> Really Red High Reflective Starlight	NXT-RRHRS	\$150	Note: Floor to seat rail height range is 14" to 18.5"		
<input type="radio"/> Really Red High Reflective Starlight	NXT-RRHRS	\$150	Note: The NXT comes in 3 sizes. Each size has 4" of back post tube adjustment Frame depth is measured from the front of the back post tube to the front end of the NXT seat frame To determine back post tube location, add seating and hardware thickness (planar back and hardware typically equals 2") to seating cushion depth Example: Seating cushion in front of back support Seating cushion depth = 12" Back and hardware thickness = 2" Back post tube location = 14"		
<input type="radio"/> Pink Parfait High Reflective Starlight	NXT-PINKHRS	\$150	Seat Rail Extensions		
<input type="radio"/> Yellow High Reflective Starlight	NXT-YHRS	\$150	Please choose frame size and extension length.		
Note: High reflective starlight is a second coating designed to reflect light to make night travel safer			<input type="radio"/> Short	<input type="radio"/> Medium	
			<input type="radio"/> 2"	<input type="radio"/> 2"	NXT-30525 n/c
				<input type="radio"/> 3"	NXT-30530 n/c
			Note: Seat rail extensions may limit tilt range with 22" & 24" rear wheels Extensions may affect stability when in the tilt position Adjusting seat rail forward will help compensate for possible tilt range limitations and instability when in the tilted position		

Date: _____ P.O.# _____

Marked for: _____

Description Part No. Retail

Description Part No. Retail

Back Post Tubes

- Traditional Bend Push Handles NXT-30518 n/c
 - Ergo Bend Push Handles NXT-30519 n/c
- Note: Push Handle Extensions and Stroller Handle Extensions not recommended with Ergo Bend Push Handles



Traditional



Ergo

Height Options

- Short (19" High) NXT-30515 n/c
 - Medium (23" High) NXT-30514 n/c
 - Tall (26" High) NXT-30516 n/c
- Note: Back post tube heights are measured from top of seat frame to top of handle bend

Extension Options

- Push Handle Extension Width Adjustable Removable NXT-30513 n/c
 - Stroller Handle Extension Width Adjustable Removable NXT-30526 **\$125**
 - Individual Stroller Handle Extensions (pair) Removable NXT-30517 **\$100**
- Note: Stroller handle extensions add approximately 6.5" to push handle height
 Note: Push Handle Extensions and Stroller Handle Extensions not recommended with Ergo Bend Push Handles



Push Handle Extension



Stroller Handle Extension



Individual Stroller Push Handles

Swing Away Hangers

- Omit Hangers & Footplates NXT-33000 **(\$30)**
- Pop-Up Swing Away 75° Hanger NXT-30280 n/c
- Pop-Up Swing Away 90° Hanger NXT-30281 n/c
- Latch Style Swing Away 75° Hanger NXT-30282 n/c
- Latch Style Swing Away 90° Hanger NXT-30283 n/c
- Pop-Up Swing Away Elevating (E0990) NXT-30279 **\$235**



90° Pop-up



75° Latch Style



Elevating

Hanger Extensions

- 4.5" Extension NXT-36402 **\$ 55**
 - 6.5" Extension NXT-36403 **\$ 65**
 - High Mount Clamp (K0037) NXT-36407 **\$100**
- Note: 6.5" not available with 90° hangers.
 Note: High Mount Clamps not available on 75° hangers

Knee to Heel Measurement _____ Inches

Hanger Extension Configuration	Knee to Heel Range (from seat rail)
Hanger and high mount clamp	4" - 9"
Hanger only	6" - 9"
Hanger and 4.5" extension	to 13.5"
Hanger and 6.5" extension	to 15.5"

Foot Plate Options

- Omit Footrest Plate NXT-36404 **(\$15)**
- Composite Flip Up NXT-17070 n/c
- Kids Aluminum Angle Adj. Flip Up (K0040) NXT-36020 **\$150**
 Note: For Frames 14" wide and under
- Heel Loop (E0951) NXT-36022 **\$ 50**
- Adult Aluminum Angle Adj. Flip Up with Heel Loop (K0040) (E0951) NXT-36021 **\$150**
 Note: For Frames 15" wide and over
- Omit Heel Loop NXT-36023 n/c
- Aluminum Angle Adj. Footboard Removable NXT-36029 **\$150**



Composite Flip-up Footplate

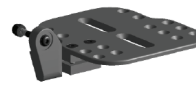

Angle Adjustable Flip-up Footplate



Removable Footboard

Armrests

Armrests Attached to Back Post Tube

- Omit Flip Back Arms NXT-38209 **(\$20)**
- Flip Back Standard 13" Long NXT-38204 n/c
- Flip Back Long 16" Long NXT-38202 n/c
- Flip Back Telescoping (E0973) NXT-38208 **\$100**
- Locking Flip Back Std. 13" Long (E0973) NXT-38201 **\$235**
- Locking Flip Back Long 16" Long (E0973) NXT-38200 **\$235**
- Locking Flip Back Telescoping (E0973) NXT-38207 **\$260**

Armrests Attached to Seat Frame

- Single Post Height Adj. Removable (E0973) NXT-38203 **\$235**
- Dual Post Removable NXT-38205 n/c
- Dual Post Height Adj. Flip Back (E0973) NXT-38206 **\$245**
 Note: Dual Post Armrest Options not available on short NXT frame

Armrest Pad

- Desk Length NXT-38213 n/c
 - Full Length NXT-38214 n/c
- Note: Full length on 16" armrests only

Seat Rail to Top of Armrest Measurement _____ Inches



Locking Flip Back Armrest



Single Post Height Adjustable Armrest



Dual Post Height Adjustable Removable Armrest

Date: _____ P.O.# _____

Marked for: _____

Description	Part No.	Retail
Front Caster Wheels		
<input type="radio"/> Omit Caster Wheels	NXT-34333	n/c
<input type="radio"/> 3" Poly	NXT-34888	\$ 55
<input type="radio"/> 3" Light Up	NXT-34111	\$ 55
<small>Note: 3" casters are recommended for low frame configurations</small>		
<input type="radio"/> 4" Poly	NXT-40000	\$ 65
<input type="radio"/> 4" Light Up	NXT-41000	\$ 99
<input type="radio"/> 4" x 1.4" Poly Aluminum Mag	NXT-43000	\$ 90
<input type="radio"/> 5" Poly	NXT-34555	n/c
<input type="radio"/> 5" x 1.5" Poly	NXT-34222	\$ 85
<input type="radio"/> 5" x 1.4" Poly Aluminum Mag	NXT-42000	\$ 90
<input type="radio"/> 6" Poly	NXT-34666	n/c
<input type="radio"/> 6" x 1.5" Poly	NXT-34999	\$ 85
<input type="radio"/> 6" x 1.4" Poly Aluminum Mag	NXT-44000	\$ 90
<input type="radio"/> 6" x 2" Poly with Tread	NXT-34444	\$ 90
<input type="radio"/> 6" Pneumatic (E2214 / E2215)	NXT-34667	\$ 75
<small>Note: All 6" casters not available with all 16" rear wheel options</small>		
<input type="radio"/> 7" Poly	NXT-34777	\$ 75
<input type="radio"/> 7" x 1.5" Poly	NXT-34000	\$116
<input type="radio"/> 7" x 2" Poly	NXT-34200	\$116
<small>Note: All 7" casters not available with all 12" rear wheel options</small>		



5" Poly



5" x 1.5" Poly



5" x 1.4" Poly Aluminum Mag

Rear Wheels, Tires and Accessories
Mag Wheel Tire Options

<input type="radio"/> Omit Wheels and Axles	NXT-31524	(\$55)
<input type="radio"/> 12" Pneumatic Mag	NXT-31525	n/c
<input type="radio"/> 12" Poly Mag (E2218)	NXT-31526	\$ 35
<input type="radio"/> 12" Semi Pneumatic Mag	NXT-31523	\$165
<small>Note: Handrims are not available with 12" wheel options</small>		
<small>Note: All 12" wheels not available with all 7" caster options</small>		
<input type="radio"/> 16" Pneumatic Mag	NXT-31530	\$ 40
<small>Note: All 16" wheels not available with all 6" caster options</small>		
<input type="radio"/> 18" Pneumatic Mag	NXT-31533	\$ 35
<input type="radio"/> 20" Pneumatic Mag w/Alum. Handrim	NXT-31527	n/c
<input type="radio"/> 22" Pneumatic Mag w/Alum. Handrim	NXT-31528	n/c
<input type="radio"/> 24" Pneumatic Mag w/Alum. Handrim	NXT-31529	n/c
<input type="radio"/> Omit Handrims	NXT-31006	(\$25)
<small>Note: 22" & 24" wheels not available with short tilt bracket</small>		
<small>Note: Patented double locking safety axle receiver included at no charge</small>		

Spoke Wheel Tire Options

<input type="radio"/> 20" Pneumatic Spoke	NXT-31540	\$200
<input type="radio"/> 22" Pneumatic Spoke	NXT-31541	\$200
<input type="radio"/> 24" Pneumatic Spoke	NXT-31542	\$200
<input type="radio"/> Omit Handrims	NXT-31006	(\$25)
<small>Note: 22" & 24" wheels not available with short tilt bracket</small>		
<small>Note: Plastic coated handrims not available with spoke wheel options</small>		
<small>Note: Patented double locking safety axle receiver included at no charge</small>		

Wheel Accessories

<input type="radio"/> Aluminum Handrims 16" & 18" (pr.)	NXT-31007	\$166
<input type="radio"/> Plastic Coated Handrims (pr.)	NXT-31005	\$117
<small>Note: Plastic coated handrims not available with spoke wheels</small>		
<small>Note: Handrims are not available with all 12" wheel options</small>		
<input type="radio"/> Airless Inserts (E2213)	NXT-31000	\$ 75

Description	Part No.	Retail
Wheel Locks		
<input type="radio"/> Push to Lock	NXT-31501	n/c
<input type="radio"/> Pull to Lock	NXT-31506	n/c
<input type="radio"/> Wheel Lock Handle Extensions (E0961)	NXT-31801	\$ 60
<input type="radio"/> Foot Actuated Lock	NXT-31508	n/c
<small>Note: Not available with vent tray or battery tray options</small>		
<small>Note: If both foot actuated lock and manual wheel locks are ordered together, an "off-chair" charge will apply</small>		

Rear Anti-Tip

<input type="radio"/> Anti-Tip Tubes—Flip (E0971)	NXT-31603	\$ 95
<small>Note: One pair of flip-up anti-tip tubes.</small>		
<input type="radio"/> Anti-Tip Tubes with Curb Assist	NXT-31600	\$ 95
<small>Note: Each anti-tip tube pair includes one with curb assist</small>		

Floor To Seat Rail Height Matrix

Rear Wheel	Front Caster	Short & Medium Frames Short Tilt Bracket	Medium & Long Frames Tall Tilt Bracket
12"	3"	13"	14.5"
12"	3"	15"	16.5"
12"	4"	15.5"	17"
12"	4"	16"	17.5"
12"	5"	15.5"	17"
12"	5"	16"	17.5"
12"	6"	15.5"	17"
12"	6"	16"	17.5"
16"	3"	12.5"	14"
16"	4"	13.5"	15"
16"	3"	14"	15.5"
16"	4"	14"	15.5"
16"	5"	14.5"	16"
16"	3"	15"	16.5"
16"	5"	15"	16.5"
18"	3"	13.5"	15"
18"	3"	14"	15.5"
18"	4"	14"	15.5"
18"	4"	15"	16.5"
18"	5"	15.5"	17"
18"	6"	15.5"	17"
18"	6"	16"	17.5"
20"	5"	15.5"	17"
20"	6"	15.5"	17"
22"	7"	n/a	18"
24"	7"	n/a	18.5"

Rider Capacity - 225 lbs.

Date: _____ P.O.# _____

Marked for: _____

Description	Part No.	Retail
-------------	----------	--------

Description	Part No.	Retail
-------------	----------	--------

Accessories

- Medical necessities Bag** (black only) NXT-23207 \$ 67
- Back Pack** (black only) NXT-TFBP \$ 55
- Canopy** NXT-38750 \$150
- Canopy with Visor** NXT-38756 \$175
Note: Canopies on NXT with transport option must be removed during transport

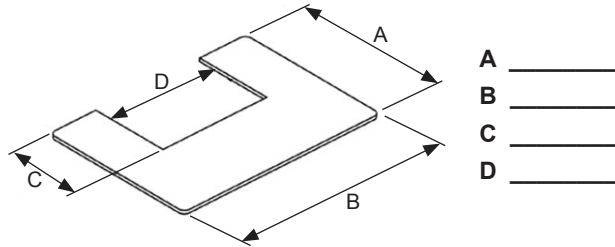

Trays / Lapboards (E0950)

- Lexan Tray - No Hardware** 08-8000 \$156
- Lexan Tray - Adj. Knob Hardware** 08-6000 \$215
- EZ-Lite Lexan Tray - .25" Thick** 08-12000 \$167
- EZ-Lite Lexan Tray with Ribs** 08-13000 \$179
- Lexan Tray with 1" Locking Hooks** 08-15000 \$198
- .25" Lexan Tray -without Hardware** 08-17000 \$ 93

Solid Back Options

- Easy Conforming Back - Standard** 102-12000 \$839
(4 point hardware)Note: Uses 4 point hardware
- Easy Conforming Back - Standard with 2 J/L's, Glide Locks & Hinges** EZ Conf 2 \$839
Note: Uses seat to back attachment hinge
- Mod-2Econo2** Mod-2Econo2 Add \$ 45
Note: 2 Econo Eze clamps instead of 2 J/L's and Glide Locks for EZ Conf2
- Split Wing** Mod-2QQ \$186

Head Support Options

- Rock & Roll Headrest Hardware** 7708 \$385
- Chubbie Head Support Pad** 7756 \$184
 - Small Medium Large
- Low Profile Occipital Headrest Pad** 7757 \$133
 - Small Medium Large



***Pelvic Positioning Belts (E0978)**

Streamline - Two Point Padded

- Center Pull - Metal Push Button Buckle** SB-3332 \$ 88
- Center Pull - Metal Push Button Buckle with 1" Buckle & .75" Webbing** SB-3332-1 \$ 88
- Center Pull - EZ Release Push Button Buckle** SB-3334 \$ 88

Streamline - Non- Padded

- Center Pull - Metal Push Button Buckle** SB-3410 \$ 29
- Hipster - Two Point Padded**
- Center Pull - Metal Push Button Buckle** HIP-3002 \$109
- Center Pull - EZ Release Push Button Buckle** HIP-3004 \$109

Hipster - Non-Padded

- Center Pull - Metal Push Button Buckle** HIP-3021 \$ 50
- Center Pull - Metal Push Button Buckle with 1" Buckle & .75" Webbing** HIP-3021-1 \$ 50

* Note: Many other belts are available - those shown above include some of our most popular
 Ask your customer service representative about additional styles

Solid Seat Options

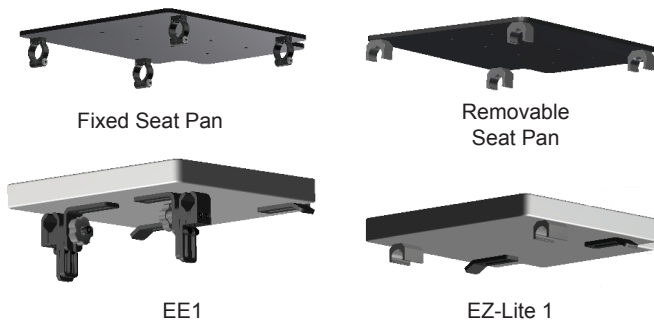

- Fixed Solid Seat Pan** NXT-39010 \$100
 Width _____ X Depth _____
- Removable Solid Seat Pan** NXT-39012 \$150
 Width _____ X Depth _____
- Solid Seat with Econo-EZE Hardware** EE1 \$548
Note: Uses 30 degree brackets at rear of cushion
- Solid Seat with EZ-Lite Hardware** EZ Lite 1 \$400
Note: Uses 30 degree brackets at rear of cushion